

**campus was launched in
1962
built by prisoners**



Values

- Openness and innovation
- Loyalty
- Partnership and tolerance
- Professionalism



Main targets



- To enhance the **quality of higher education and R&D**
- To increase the **number of international students and personnel**
- To establish **international knowledge networks and transfer**



1918

TALLINNA TEHNIKAÜLIKOOL
TALLINN UNIVERSITY OF TECHNOLOGY

Tallinn University of Technology

■ campus area: 53 ha

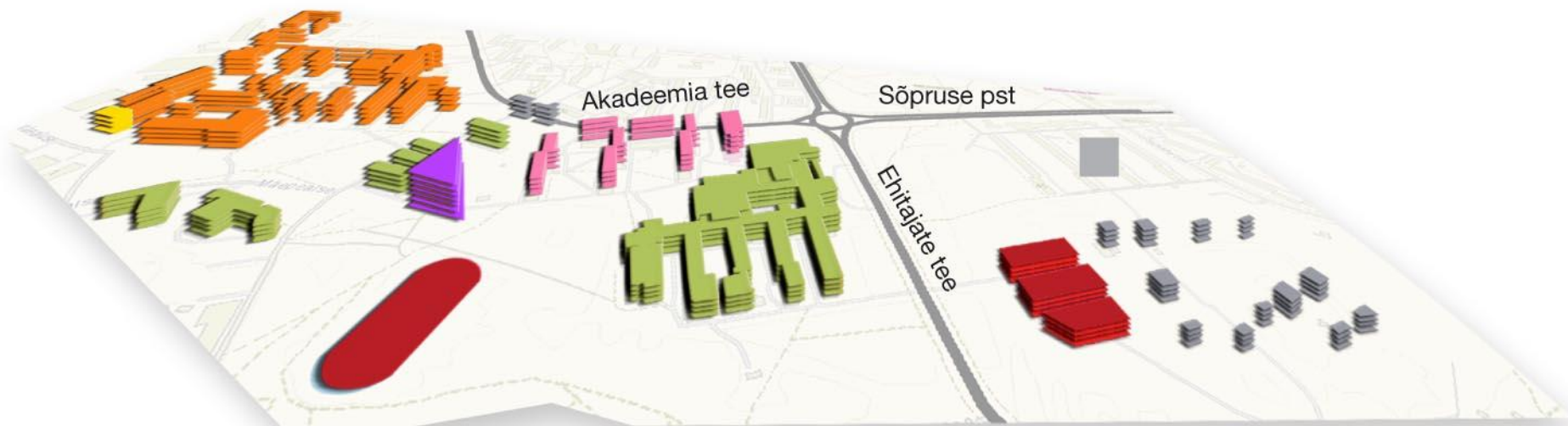

TEHNOPOL



TEHNOPOL BUSINESS INCUBATOR



SPORTS BUILDINGS



TALLINN UNIVERSITY OF TECHNOLOGY



UNIVERSITY DORMITORIES



IT COLLEGE



1918

TALLINNA TEHNIKAÜLIKOOL
TALLINN UNIVERSITY OF TECHNOLOGY

Tallinn University of Technology

faculty of civil
engineering



we are here now



1918

TALLINNA TEHNIKAÜLIKOOL
TALLINN UNIVERSITY OF TECHNOLOGY



1918

TALLINNA TEHNIKAÜLIKOOL
TALLINN UNIVERSITY OF TECHNOLOGY



1918

TALLINNA TEHNIKAÜLIKOOL
TALLINN UNIVERSITY OF TECHNOLOGY

DELFI
delfi.ee



1918
TALLINNA TEHNIKAÜLIKOOL
TALLINN UNIVERSITY OF TECHNOLOGY

DELE
pilt delfi.ee



1918

TALLINNA TEHNIKAÜLIKOOL
TALLINN UNIVERSITY OF TECHNOLOGY



1918
TALLINNA TEHNIKAÜLIKOOL
TALLINN UNIVERSITY OF TECHNOLOGY

DELFT
pitt.delft.nl

Tallinn University of Technology



- type of institution: public university
 - year of establishment: 1918
- 8 faculties
- 33 departments and 113 chairs
- 9 faculty research centers
- 10 affiliated institutions,
 - incl. 4 regional colleges
- languages:
 - Estonian, Russian and English



1918

TALLINNA TEHNIKAÜLIKOOL
TALLINN UNIVERSITY OF TECHNOLOGY

Faculties



- **Chemistry and Materials Technology**
- **Civil Engineering**
- **Information Technology**
- **Mechanical Engineering**
- **Power Engineering**
- **School of Economics and Business Administration**
- **Science**
- **Social Sciences**



1918

TALLINNA TEHNIKAÜLIKOOL
TALLINN UNIVERSITY OF TECHNOLOGY



1918

TALLINNA TEHNIKAÜLIKOOL
TALLINN UNIVERSITY OF TECHNOLOGY

R&D institutions

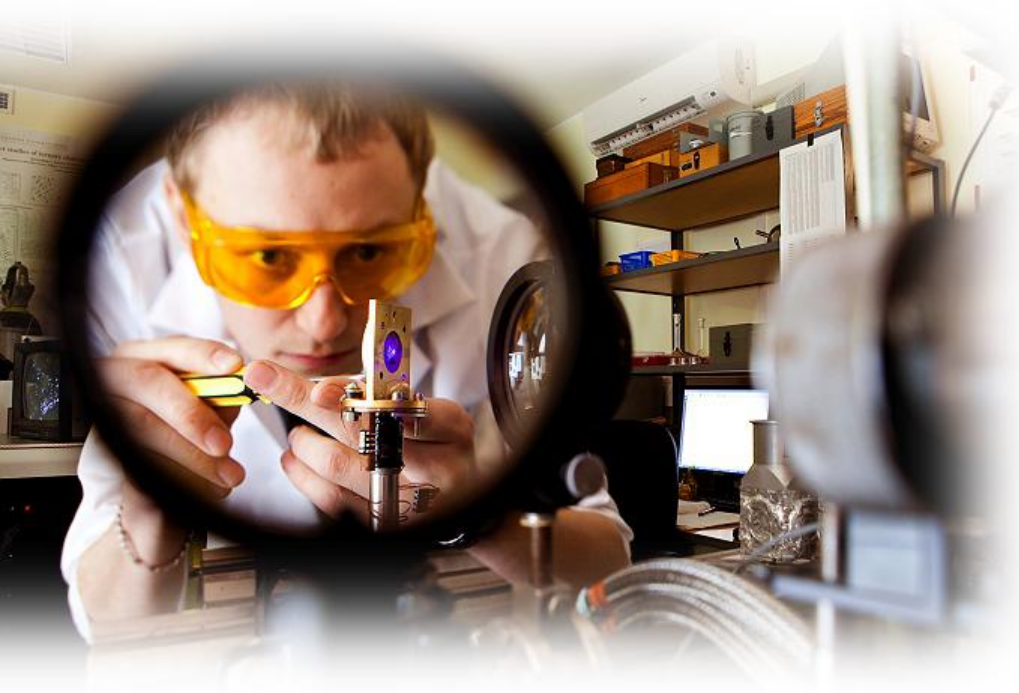

- Institute of Geology
- Institute of Cybernetics
- Institute of Marine Systems
- Certification Centre of TUT
- Technomedicum of TUT
- Library

Colleges (4):

- Tallinn College
- Tartu College (in Tartu)
- Kuressaare College (in Saaremaa)
- Virumaa College (in Kohtla-Järve)



1918

TALLINNA TEHNIKAÜLIKOOL
TALLINN UNIVERSITY OF TECHNOLOGY

TUT academic family

■ Academic staff	1 500
■ Administrative staff	550
■ Students	14 000



1918

TALLINNA TEHNIKAÜLIKOOL
TALLINN UNIVERSITY OF TECHNOLOGY

Students

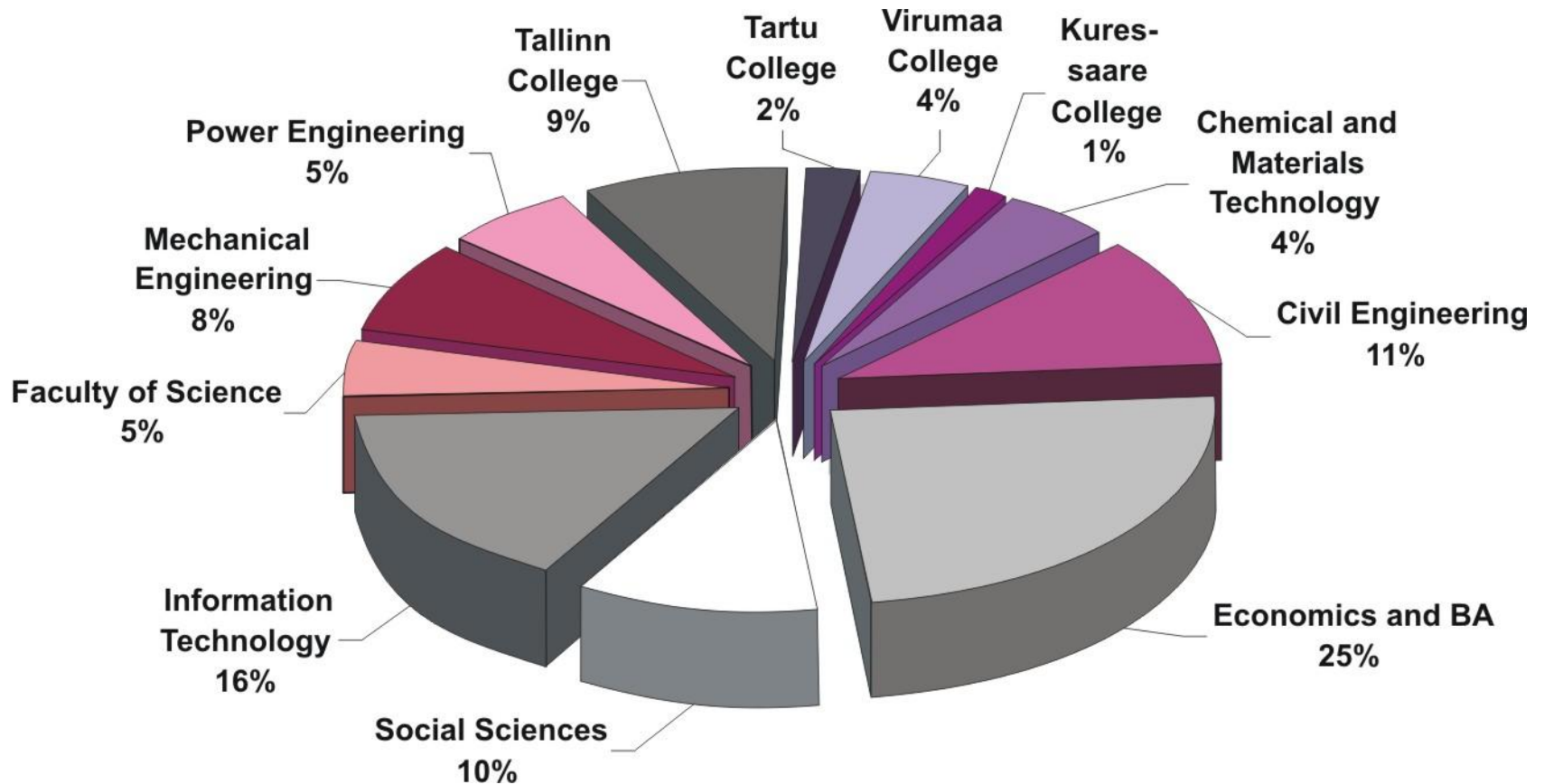

1918

TALLINNA TEHNIKAÜLIKOOL
TALLINN UNIVERSITY OF TECHNOLOGY



1918

TALLINNA TEHNIKAÜLIKOOL
TALLINN UNIVERSITY OF TECHNOLOGY

Students

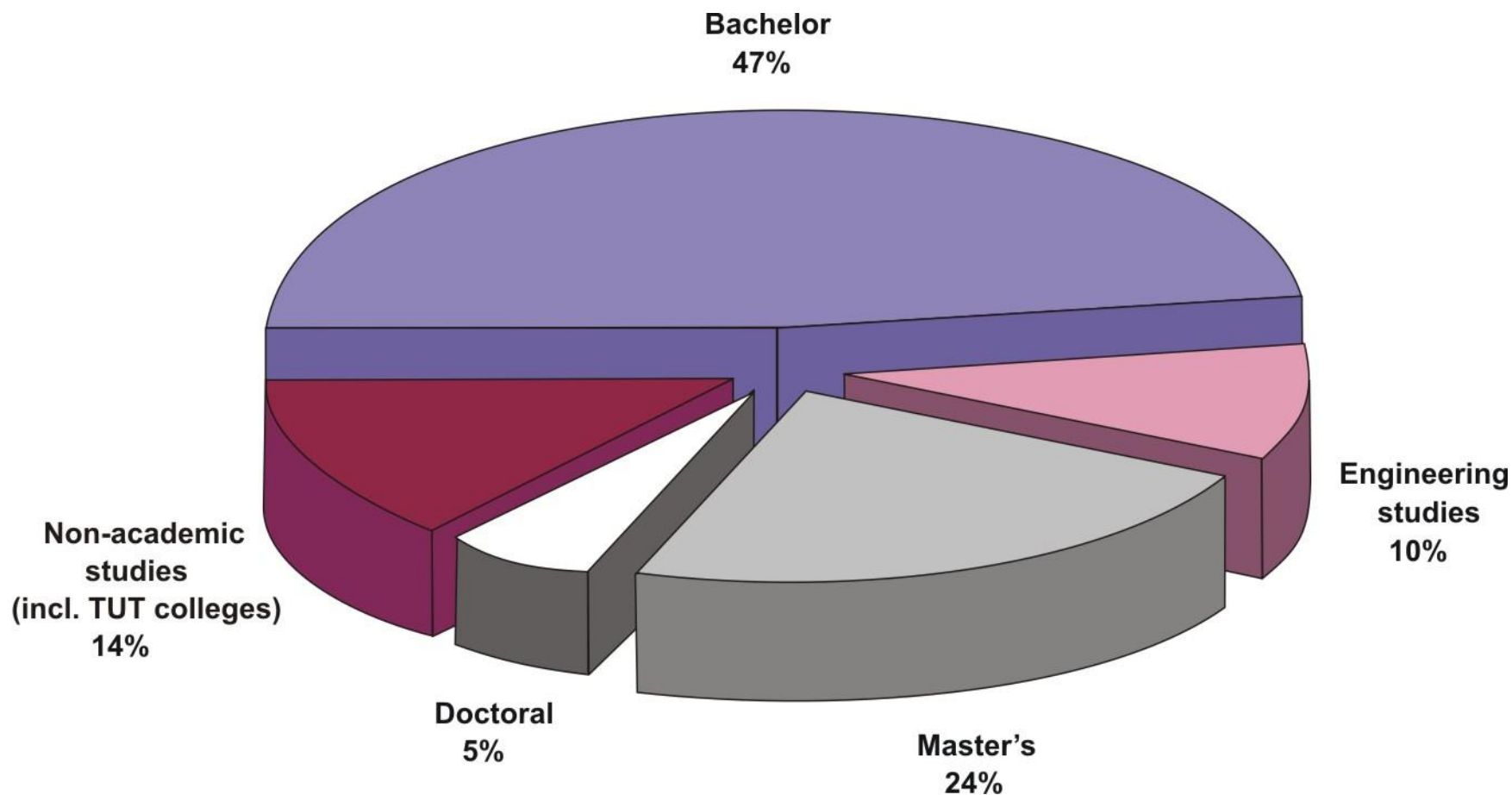

International co-operation



BALTECH

University Consortium in Science and Technology

BUP

Baltic University Program

BSRUN

The Baltic Sea Region University Network

EURAXESS

The European Services Network

UNICA

Network of Universities from the Capitals of Europe

International co-operation



EUA

The European University Association

CESAER

CESAER

the Conference of European Schools for Advanced Engineering Education and Research



ECIU

European Consortium of Innovative Universities



SEFI

European Society for Engineering Education



FEANI

European Federation of National Engineering Associations. Estonian Association of Engineers



1918

TALLINNA TEHNIKAÜLIKOOL
TALLINN UNIVERSITY OF TECHNOLOGY

Activities for society



- Life learning program
- Programs for high schools
- Regional development
- Cultural activities
- Sports possibilities
- Technology and innovation centre
- etc



1918

TALLINNA TEHNIKAÜLIKOOL
TALLINN UNIVERSITY OF TECHNOLOGY

Cooperation with enterprises

- R&D contracts
- Certification and quality control, expertises, testing and consultations
- EU programmes and projects
- Industry scholarships
- Doctoral schools
- Students' practical training at enterprises
- Supplementary education and retraining



Tallinn Technology Park – Tehnopol

Established by

- TUT
- City of Tallinn and
- Republic of Estonia

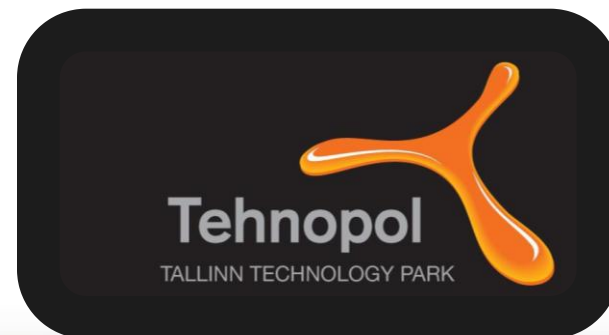

Basic data:

- 46,000 m² rental area
- 10 ha land
- 130 high-tech firms

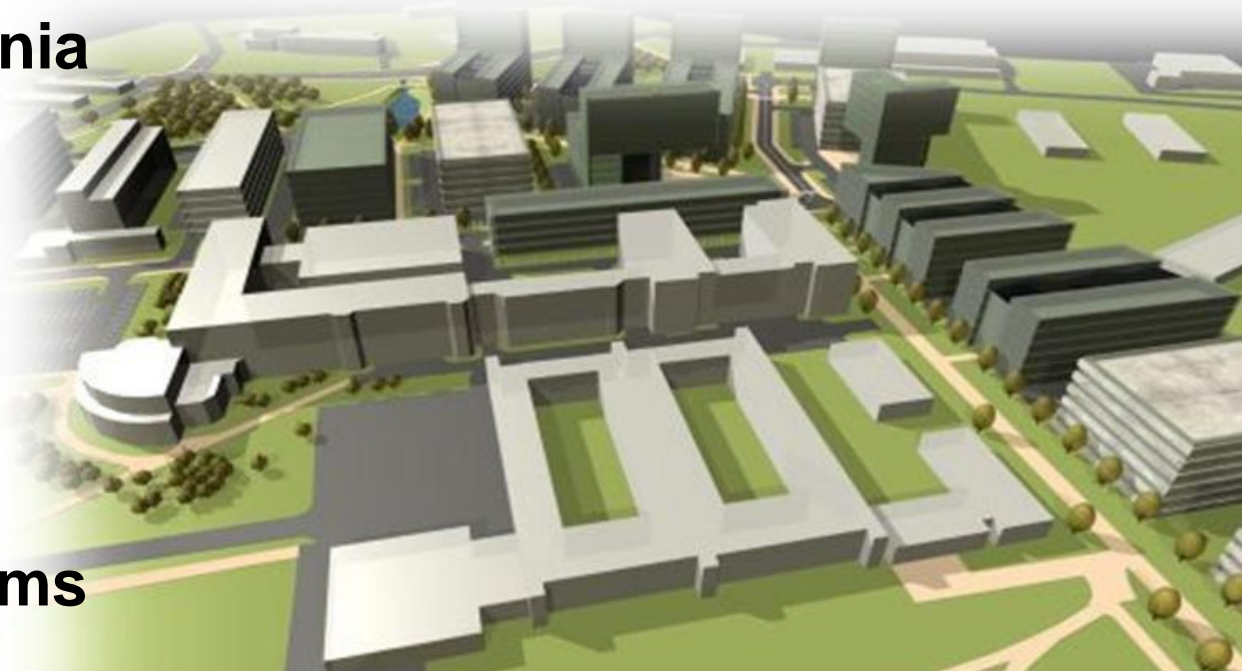

1918

TALLINNA TEHNIKAÜLIKOOL
TALLINN UNIVERSITY OF TECHNOLOGY

Faculty of Civil Engineering



some facts from history

- **TUT was founded as an engineering college in 1918**
 - ▣ **in this moment totally 120 students**
 - **in civil engineering 19**
 - **in architecture 6**
- **TUT acquired status of an university in 1936**
 - ▣ **civil engineering was the largest department**
 - **road engineering**
 - **civil engineering**
 - **coastal engineering**
 - **bridges**
 - **structures**
- **in 1937 (July):**
 - ▣ **195 students in civil engineering**





- **until 1966 the faculty was located in the the former main building of TUT**
- **since then removed to Mustamäe campus**
- **reco-works of the building of the Faculty for Civil Engineering until autumn 2006**

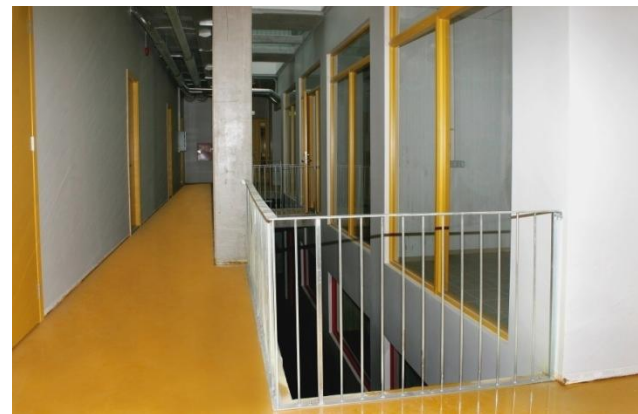

1918

TALLINNA TEHNIKAÜLIKOOL
TALLINN UNIVERSITY OF TECHNOLOGY



1918

TALLINNA TEHNIKAÜLIKOOL
TALLINN UNIVERSITY OF TECHNOLOGY

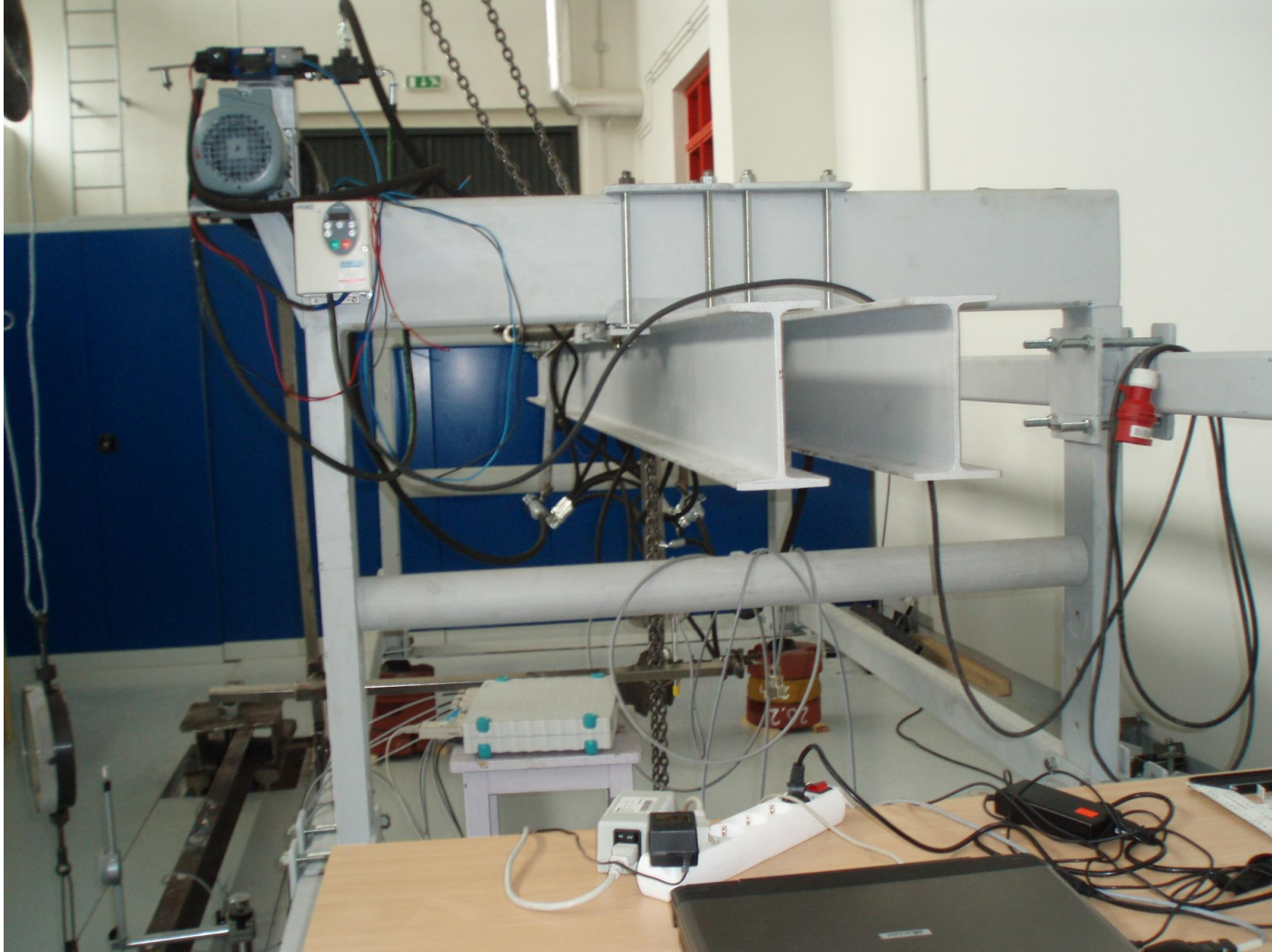

1918

TALLINNA TEHNIKAÜLIKOOL
TALLINN UNIVERSITY OF TECHNOLOGY

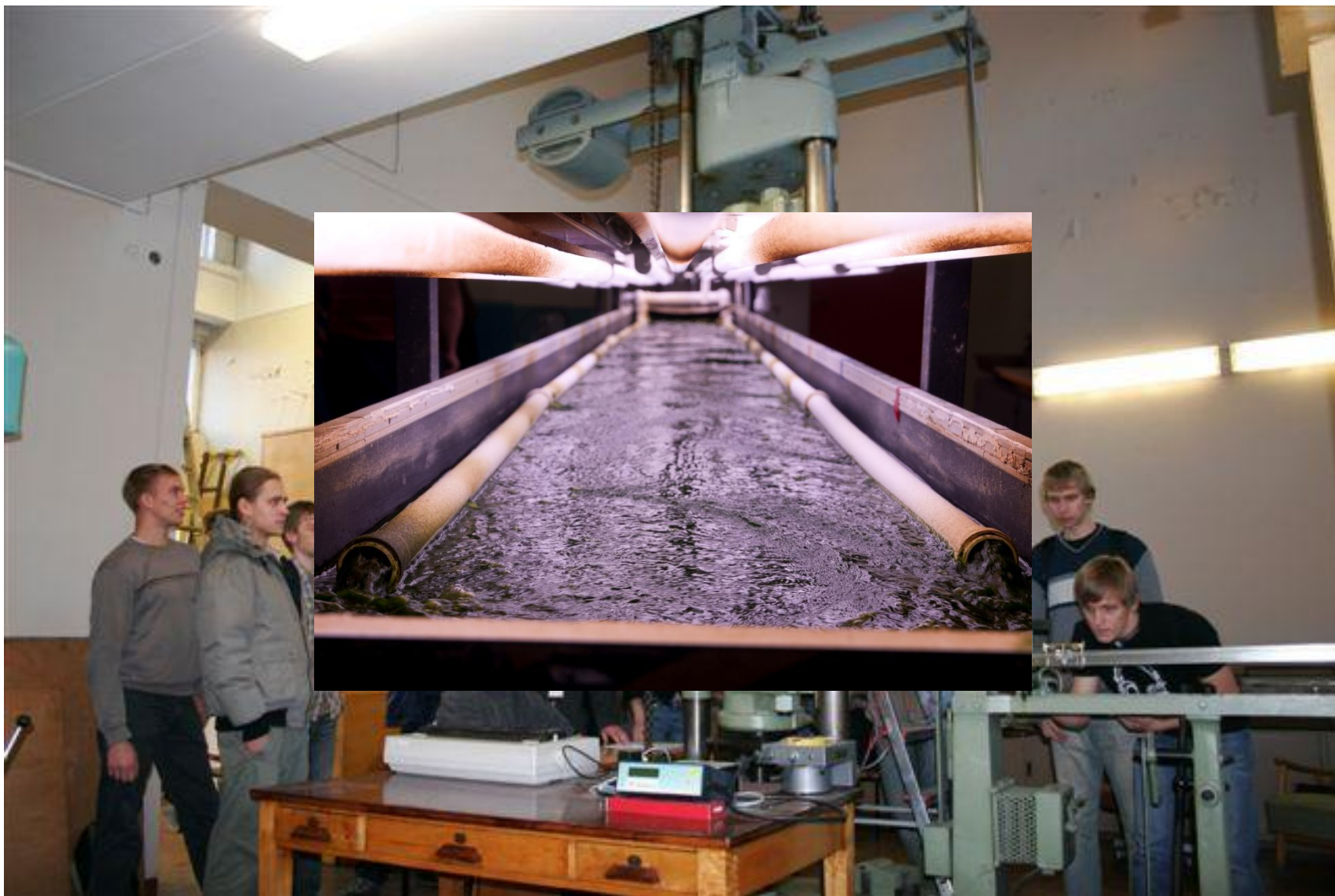



1918

TALLINNA TEHNIKAÜLIKOOL
TALLINN UNIVERSITY OF TECHNOLOGY



1918

TALLINNA TEHNIKAÜLIKOOL
TALLINN UNIVERSITY OF TECHNOLOGY



1918

TALLINNA TEHNIKAÜLIKOOL
TALLINN UNIVERSITY OF TECHNOLOGY

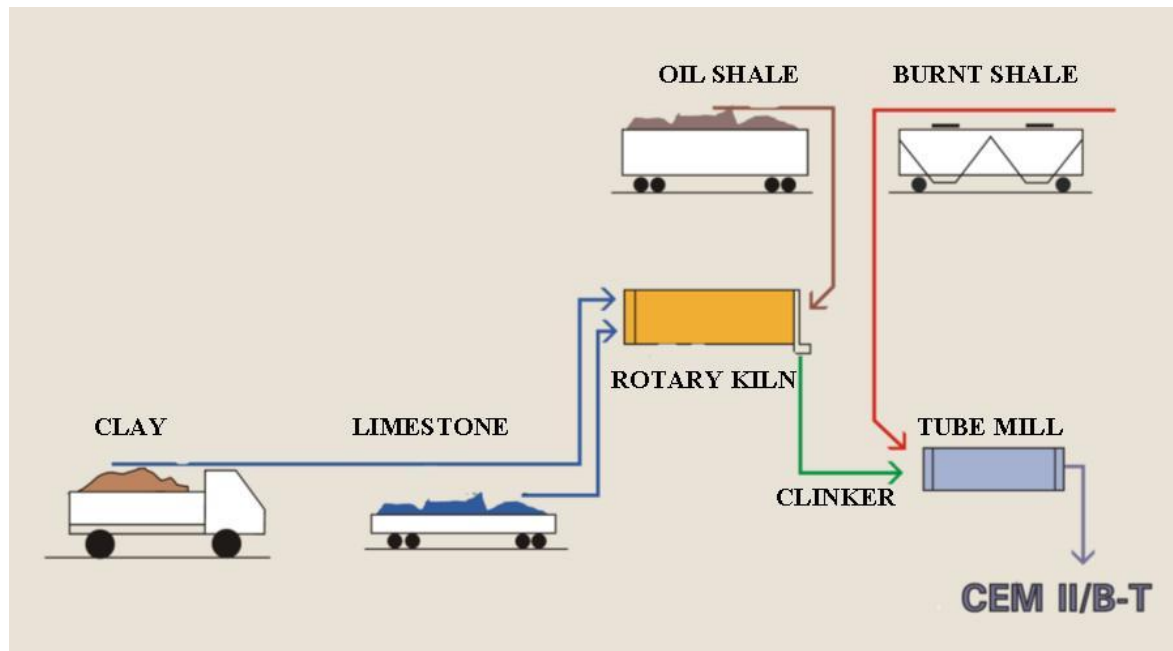
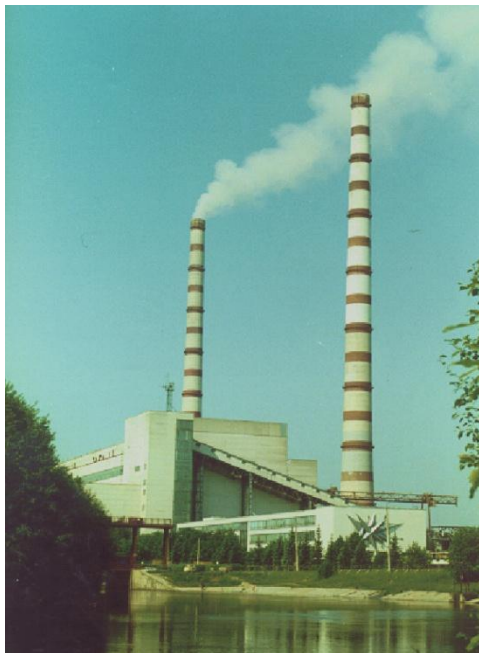



1918

TALLINNA TEHNIKAÜLIKOOL
TALLINN UNIVERSITY OF TECHNOLOGY

specialisations in Civil Engineering

environmental management	
heating and ventilation	
water engineering	
engineering surveying	
bridge construction	
road engineering	
construction economics & management	
construction engineering	
coastal engineering & harbour structures	
logistics (bachelors + magisters)	
architects (since 2012)	



1918

TALLINNA TEHNIKAÜLIKOOL
TALLINN UNIVERSITY OF TECHNOLOGY



1918

TALLINNA TEHNIKAÜLIKOOL

TALLINN UNIVERSITY OF TECHNOLOGY

Thank you!

